

Bypass Feeder

Chemical Addition and Filtering

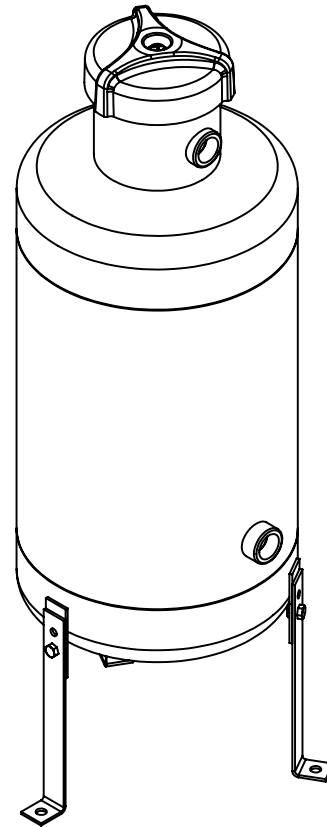

Key Features

- Powder Coated
- Handle-top filter holder
- Full bottom drain
- Flat and dome bottom models
- Custom configurations
- Adjustable leg kit
- ACME cap

Application

Bypass Feeders are designed to provide a dependable means of introducing treatment chemicals into hot and cold water or other liquid streams with a large filtration capacity.

Bypass Feeders have a simple design that provides easy installation and operation with precise filtering capabilities. The coarse ACME thread cap design provides better sealing and quick opening.

Build a Model

Select the desired capacity, bottom, and filter, plus any options.
(Example: BF-05DX)

BF- _____

Capacity _____

02 = 2 gallon
05 = 5 gallon
12 = 12 gallon

Bottom _____

D = Dome with legs and bottom port
F = Flat

Filter _____

- X = no filter
1 = 10" cartridge filter holder (20 micron hot filter included)
2 = 18" bag filter basket (25 micron bag included)
3= 18" bag filter basket (5 micron bag included)
4= 18" bag filter basket (no handle or filter)

Accessory Kits

- BFK-ISOVALVES 3/4" brass isolation valves w/ unions & nipples
BFK-DBDRAIN 3/4" brass drain valve & fittings for dome bottom
BFK-FBDRAIN 3/4" brass drain valve & fittings for flat bottom
BFK-GAUGEX 3/4" cross w/ 0-300 psi gauge, sample/relief valve 180°F & fittings
BFK-FUNASM 3/4" tee, isolation valve and funnel

Parts

- BF-BAG0518 18" x 3" bag filter, 05 micron
BF-BAG2518 18" x 3" bag filter, 25 micron
BF-BGCAGE18 Bypass feeder SS bag filter cage, 18"
BF-BGCAGE18-F Bypass feeder SS bag filter cage, no handle
BF-CF05-10 10" cold water cartridge filter, 05 micron
BF-CF20-10 10" cold water filter, 20 micron
BF-HF05-10 10" hot water cartridge filter, 05 micron
BF-HF20-10 10" hot water filter, 20 micron
BF-CFCAGE10 Bypass feeder SS cartridge filter holder, 10"
BF-CAP Bypass feeder cap assembly
BF-FUNNEL Poly funnel with 3/4" MNPT
BF-LEGS Bypass feeder leg kit
BF-ORING Bypass feeder cap O-ring
BF-PG 0-300 psi pressure gauge
BF-PLATE Bypass feeder cap plate
FLOW-2HT 3/4" flow indicator; 145 psi, 212°F max
SFS-BV 1/4" brass bleed valve, 180°F max

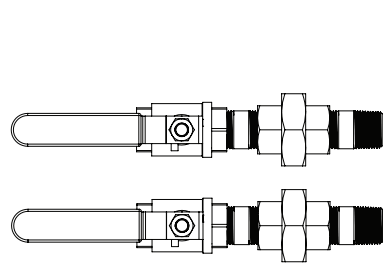

BFK-ISOVALVES

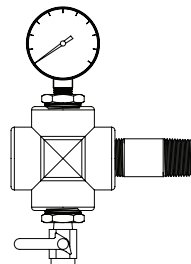

BFK-GAUGEX

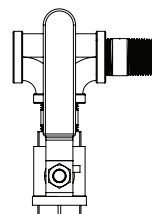

BFK-FBDRAIN

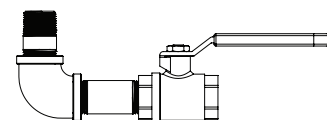

BFK-DBDRAIN

Specifications

Pressure

- 200 psi (13.6 bar) @ 225°F (107.2°C)
300 psi (20.6 bar) @ 200°F (93.3°C)

Material

11 gauge powder coated steel

Shipping Weight (approximately)

- 2 gallon (including legs) = 24.5 lbs (11.11 kg)
5 gallon (including legs) = 35.5 lbs (16.1 kg)
12 gallon (including legs) = 52 lbs (23.59 kg)
Basket = 0.6 lb (0.27 kg)
Filter Holder = 0.85 lb (0.39 kg)

Dimensions

Model	A	B	C	D	E
BF-02D	6"	34"	10.8"	19.7"	6.6"
BF-02F	6"	26.7"	3.6"	19.7"	6.6"
BF-05D	10"	35.5"	12.3"	19.8"	10.6"
BF-05F	10"	27.5"	4.3"	19.8"	10.6"
BF-12D	10"	49.5"	12.3"	37.2"	10.6"
BF-12F	10"	45"	4.3"	37.2"	10.6"

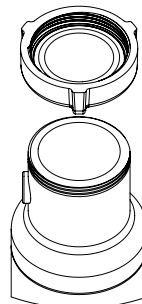

ACME Cap

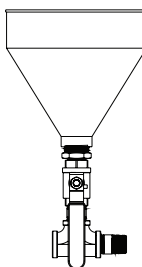

BFK-FUNASM

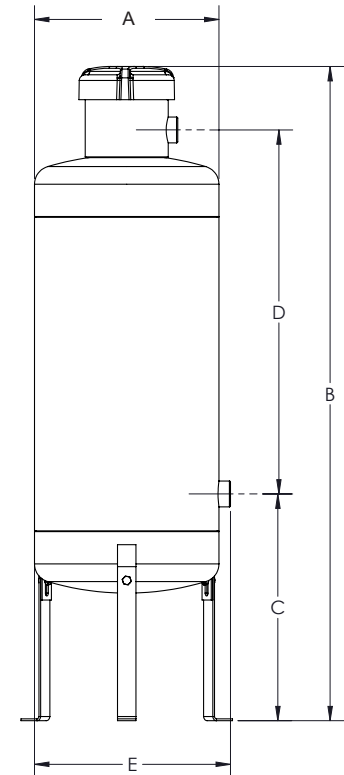

Get the Advantage



4700 Harold-Abitz Dr
Muskogee, OK 74403
800-743-7431 Phone
888-686-6212 Fax
www.advantagecontrols.com